



LANDMARK CENTER

75 West 5th Street Saint Paul, MN 55102



Wonderful historic, creative space available in Downtown St. Paul. Great environment for all users who seek inspiring places to work. Special rates for creative/programmatic non-profits.

- Approximately 7,000 sf available on the 5th floor; prefer to lease to one tenant but will consider subdividing
- On-site management
- Competitive rental rates, particularly for non-profit users
- A variety of meeting spaces available
- Located on Rice Park next to Ordway, The Saint Paul Hotel and Travelers/ Ecolab.
- Walk to the park, Xcel, Starbucks, Pazzaluna, Kincaids or many other restaurants and shops

FOR LEASE

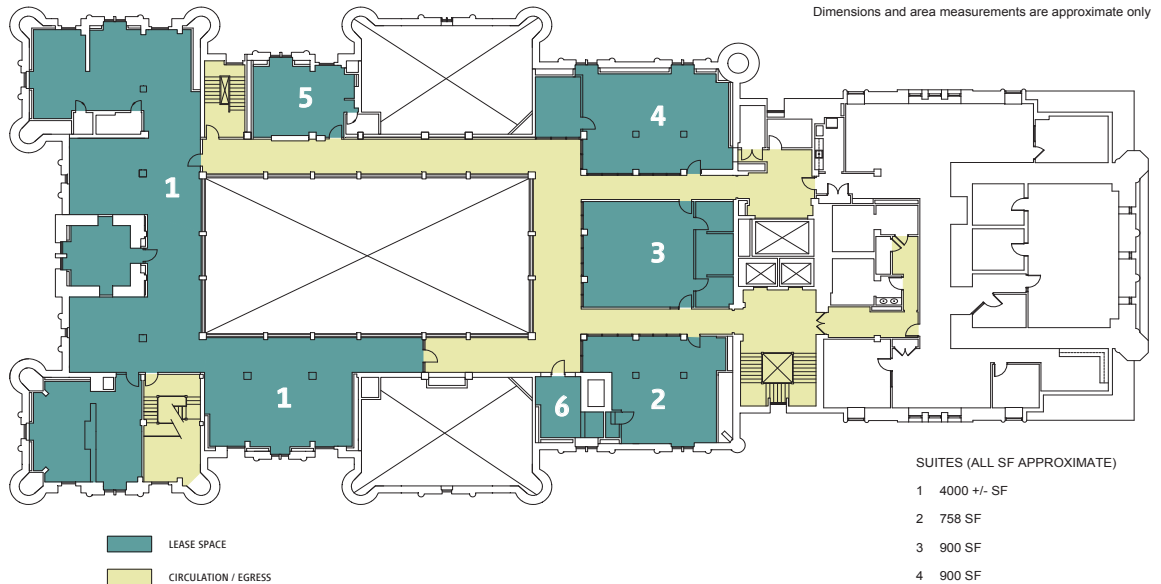

SUITES (ALL SF APPROXIMATE)	
1	4000 +/- SF
2	758 SF
3	900 SF
4	900 SF
5	348 SF
6	189 SF

LANDMARK CENTER FIFTH FLOOR
PROPOSED TENANT SPACES
approx. 7,000 SF leasable

Marketing Assistance by:



For More Information:

Amy Mino at Minnesota Landmarks
(651) 292-3285
amino@landmarkcenter.org